



Licensing Sub-Committee

Date: Wednesday, 1 December 2021
Time: 10.00 am
Venue: Committee Room 1, County Hall, Dorchester, DT1 1XJ

Membership: (Quorum 3)

Councillors Jon Andrews, Les Fry and Emma Parker

Chief Executive: Matt Prosser, County Hall , Dorchester, Dorset DT1 1XJ

For more information about this agenda please telephone Democratic Services 01305 224202 elaine.tibble@dorsetcouncil.gov.uk



For easy access to the Council agendas and minutes download the free public app Mod.gov for use on your iPad, Android and Windows tablet. Once downloaded select Dorset Council.

Members of the public are welcome to attend this meeting with the exception of any items listed in the exempt part of this agenda. Please note that if you attend a committee meeting and are invited to make oral representations your name, together with a summary of your comments will be recorded in the minutes of the meeting. Please refer to the guide to public participation at committee meetings for more information about speaking at meetings. There is a Hearing Loop Induction System available for public use on request. Please speak to a Democratic Services Officer for assistance in using this facility. Recording, photographing and using social media at meetings Dorset Council is committed to being open and transparent in the way it carries out its business whenever possible. Anyone can film, audio-record, take photographs, and use social media such as tweeting and blogging to report the meeting when it is open to the public, so long as they conform to the Protocol for filming and audio recording of public council meetings.

A G E N D A

Page No.

1 ELECTION OF CHAIRMAN AND STATEMENT FOR THE PROCEDURE OF THE MEETING

5 - 10

To elect a Chairman for the meeting and the Chairman to present and explain the procedure for the meeting.

2 APOLOGIES

To receive any apologies for absence.

3 DECLARATIONS OF INTEREST

To disclose any pecuniary, other registrable or non-registrable interests as set out in the adopted Code of Conduct. In making their disclosure councillors are asked to state the agenda item, the nature of the interest and any action they propose to take as part of their declaration.

If required, further advice should be sought from the Monitoring Officer in advance of the meeting.

4 URGENT ITEMS

To consider any items of business which the Chairman has had prior notification and considers to be urgent pursuant to section 100B (4) b) of the Local Government Act 1972. The reason for the urgency shall be recorded in the minutes.

5 WATERS EDGE CAFE

11 - 54

An application has been made for a new premises licence. The application has been out to public consultation and has attracted a relevant representation. A Licensing Sub-Committee must therefore consider the application and representations at a public hearing.

6 EXEMPT BUSINESS

To move the exclusion of the press and the public for the following item in view of the likely disclosure of exempt information within the

meaning of paragraph x of schedule 12 A to the Local Government Act 1972 (as amended).

The public and the press will be asked to leave the meeting whilst the item of business is considered.

7 TAXI DRIVER CONVICTION

55 - 70

To consider whether a driver licenced to drive both hackney carriages and private hire vehicles remains a fit and proper person to continue to hold a licence

8 TAXI DRIVER CONVICTION

71 - 90

To consider an application for a new hackney carriage drivers' licence from a licenced private hire driver, and to consider whether the private hire drivers' licence should be retained after a number of recent motoring offences were revealed during the application process.

This page is intentionally left blank



THE LICENSING ACT 2003 (HEARINGS) REGULATIONS 2005

Rights of a Party

1. A party has the right to attend the hearing and may be represented by any person.
2. A party is entitled to give further information where the authority has asked for clarification.
3. A party can question another party, and/or address the authority, with consent of the authority.

Failure to Attend

4. If the authority is informed a party does not wish to attend, the hearing may proceed in their absence.
5. If a party has not indicated their attendance and fails to attend the hearing may be adjourned if considered in the public interest, or hold the hearing ensuring the party's representation is considered.
6. Where the authority adjourns the hearing it shall notify the parties of the date, time and place.

Procedural Information

7. At the start of the hearing, the authority shall explain the procedure which it proposes to follow and shall consider any request for permission for another person to appear at the hearing.
8. A hearing shall take the form of a discussion led by the authority and cross-examination shall not be permitted unless the authority considers that it is required.
9. The authority will allow the parties an equal maximum period of time in which to speak.
10. The authority may require any person behaving disruptively to leave, and may refuse that person to return, but such a person may, before the end of the hearing, submit in writing information they would have been entitled to give orally had they not been required to leave.

FOOTNOTE:

In relation to all other matters governed by the Licensing Act 2003 (Hearings) Regulations 2005 any party or their representative may contact the Licensing Services at Dorset Council and they will be provided with a full copy of the regulations on request.

LICENSING SUB-COMMITTEE PROCEDURE

1. At the start of the meeting the Chairman will introduce:
 - the members of the sub-committee
 - the council officers present
 - the parties and their representatives
2. The Chairman will then deal with any appropriate agenda items.
3. The Licensing Officer will be asked to outline the details of the application, including details of any withdrawn representations.
4. The applicant or their representative is then invited to present their case.
5. Committee members will be invited to ask questions.
6. Where appropriate the Responsible Bodies e.g. representatives of Police, Fire Services, Environmental Services or Trading Standards will be invited to address the sub-committee on any relevant representations they may have.
7. The Chairman may then allow an opportunity for questions.
8. The Chairman will ask any person who has made representations, who have already expressed a wish to do so, to address the sub-committee. The sub-committee will have read all the papers before them, including any letters of representation. Members of the public are asked to keep their comments concise and to the point.
9. All parties will be given the opportunity to “sum up” their case.
10. The Chairman will ask the Legal Advisor if all relevant points have been addressed before advising all parties present that the sub-committee will withdraw from the meeting to consider its decision in private. The sub-committee will be accompanied by the Democratic Services Officer and the Legal Advisor can be called upon to offer legal guidance.
11. On returning the Chairman will:
 - Notify all those present of the sub-committee’s decision (or indicate when it will be made)

- Give brief details of any conditions attached to the licence approval;
- Or
- Outline the reasons for the refusal
 - Inform that detailed reasons will follow in writing (unless given on the day)
 - Inform those present of their right to appeal to the Magistrates' Court

NOTE

The Chairman may vary this procedure, as circumstances require but will have regard to the rules of natural justice and the Licensing Act 2003 (Hearings) Regulations 2005.

The meeting will take place in public. However, the public can be excluded from all or part of the meeting where the sub-committee considers that the public interest in so doing outweighs the public interest in the meeting or that part of the meeting, taking place in public.

Under no circumstances must the parties or their witnesses offer the sub-committee information in the absence of the other parties.

The Chairman and the Sub-Committee have discretion whether to allow new information or documents to be submitted and read at the meeting.

This page is intentionally left blank

LICENSING SUB-COMMITTEE PROCEDURE

1. At the start of the meeting the Chairman will introduce:
 - the members of the sub-committee
 - the officers present
 - the parties and their representatives
2. The Chairman will then deal with any appropriate agenda items.
3. The Licensing Officer will be asked to outline the details of the application
4. The applicant or their representative is then invited to present their case.
5. Committee members will be invited to ask questions.
6. The Chairman may then allow an opportunity for questions.
7. Parties will then “sum up” their case.
- 8.. The Chairman will ask the Legal Advisor if all relevant points have been addressed before advising all parties that the sub-committee will withdraw from the meeting to consider its decision in private. The sub-committee will be accompanied by the Democratic Services Officer and the Legal Advisor to offer procedural advice and legal guidance.
9. On returning the Chairman will:
 - Notify all those present of the sub-committee’s decision (or indicate when it will be made)
 - Inform that detailed reasons will follow in writing (unless given on the day)
 - Inform those present of their right to appeal to the Magistrates’ Court

NOTE

Under no circumstances must the parties or their representatives offer the sub-committee information in the absence of the other parties.

The Chairman and the Committee have discretion whether to allow new information or documents to be submitted and read at the hearing.

May 2019

This page is intentionally left blank

Licensing Sub-Committee 1 December 2021 New Premises Licence Application for Waters Edge Café, Lyme Regis

For Decision

Portfolio Holder: Cllr L Miller, Customer and Community Services

Local Councillor(s): Cllr D Turner

Executive Director: J Sellgren, Executive Director of Place

Report Author: Aileen Powell
Title: Licensing Team Leader
Tel: 01258 484022
Email: aileen.Powell@dorsetcouncil.gov.uk

Report Status: Public

Recommendation: The Sub-Committee determines the application in the light of written and oral evidence and resolves to take such steps as it considers appropriate and proportionate for the promotion of the licensing objectives of;

- a) The prevention of crime and disorder
- b) The prevention of public nuisance
- c) Public safety
- d) The protection of children from harm

Reason for Recommendation: The Sub-Committee must consider the oral representations and information given at the hearing before reaching a decision.

1. Executive Summary

An application has been made for a new premises licence. The application has been out to public consultation and has attracted a relevant representation. A Licensing Sub-Committee must therefore consider the application and representations at a public hearing.

2. Financial Implications

Any decision of the Sub-Committee could lead to an appeal by any of the parties involved that could incur costs.

3. Well-being and Health Implications

None

4. Climate implications

None

5. Other Implications

None

6. Risk Assessment

Having considered the risks associated with this decision, the level of risk has been identified as:

Current Risk: Low

Residual Risk: Low

7. Equalities Impact Assessment

Not Applicable

8. Appendices

Appendix 1 – Application

Appendix 2 – Representation

Appendix 3 – Response to Representations

Appendix 4 – Further Correspondence

9. Background Papers

[Licensing Act](#)

[Section 182 Guidance](#)

[Dorset Council Licensing Policy](#)

10. Details

10.1. Jason Dellbridge has applied for a new premises licence for Waters Edge Café, 19 Coombe Street, Lyme Regis, DT7 3PR.

10.2. The description of the premises within the application form is for a small café predominantly selling cold food and hot and cold drinks for consumption both on and off the premises. The full application and plans for the premises are attached at appendix 1.

10.3. The application was originally to permit the on-sale of alcohol during the hours of: -

Every day 11:00 to 21:00

With the opening hours at the premises of 08:00 to 21:00.

10.4. The application has been advertised on the premises, in a newspaper and the Council's web site.

10.5. One representation has been received objecting to the application. The representation relates to the opening hours and people sitting in the outside area. The representation is included in full at appendix 2.

10.6. Following receipt of the representations the applicants has responded to the points raised, and reduced the times of alcohol sales to

Every day 11:00 to 17:00

The responses from the applicant's agent is attached in full at appendix 3.

10.7. The change to the times was communicated to the party who made the representation, who have in turn responded that they wish to continue with their representation due to the potential impact of people drinking in the outside area of the premises. The response is attached in full at appendix 4.

11. Considerations

11.1. Paragraphs 9.42 to 9.44 of the Section 182 Guidance sets how the Authority should decide what actions are appropriate.

"9.42 Licensing authorities are best placed to determine what actions are appropriate for the promotion of the licensing objectives in their areas. All licensing determinations should be considered on a case-by-case basis. They should take into account any representations or

objections that have been received from responsible authorities or other persons, and representations made by the applicant or premises user as the case may be.

9.43 The authority's determination should be evidence-based, justified as being appropriate for the promotion of the licensing objectives and proportionate to what it is intended to achieve.

9.44 Determination of whether an action or step is appropriate for the promotion of the licensing objectives requires an assessment of what action or step would be suitable to achieve that end. While this does not therefore require a licensing authority to decide that no lesser step will achieve the aim, the authority should aim to consider the potential burden that the condition would impose on the premises licence holder (such as the financial burden due to restrictions on licensable activities) as well as the potential benefit in terms of the promotion of the licensing objectives. However, it is imperative that the authority ensures that the factors which form the basis of its determination are limited to consideration of the promotion of the objectives and nothing outside those parameters. As with the consideration of licence variations, the licensing authority should consider wider issues such as other conditions already in place to mitigate potential negative impact on the promotion of the licensing objectives and the track record of the business. Further advice on determining what is appropriate when imposing conditions on a licence or certificate is provided in Chapter 10. The licensing authority is expected to come to its determination based on an assessment of the evidence on both the risks and benefits either for or against making the determination."

12. Recommendation

12.1. The Sub-Committee determines the application in the light of written and oral evidence and resolves to take such steps as it considers appropriate and proportionate for the promotion of the licensing objectives of;

- a) the prevention of crime and disorder
- b) the prevention of public nuisance
- c) public safety
- d) the protection of children from harm.

12.2. The steps that the Sub-Committee may take are:

- a) to grant the licence subject to such conditions as the authority considers appropriate for the promotion of the licensing objectives, and the mandatory conditions
- b) to exclude from the scope of the licence any of the licensable activities to which the application relates;
- c) to refuse to specify a person in the licence as the designated premises supervisor;
- d) to reject the application.

Footnote:

Issues relating to financial, legal, environmental, economic and equalities implications have been considered and any information relevant to the decision is included within the report.

This page is intentionally left blank

Application for a premises licence to be granted under the Licensing Act 2003

PLEASE READ THE FOLLOWING INSTRUCTIONS FIRST

Before completing this form please read the guidance notes at the end of the form. If you are completing this form by hand please write legibly in block capitals. In all cases ensure that your answers are inside the boxes and written in black ink. Use additional sheets if necessary.

You may wish to keep a copy of the completed form for your records.

I/We Jason Dellbridge

(Insert name(s) of applicant)

apply for a premises licence under section 17 of the Licensing Act 2003 for the premises described in Part 1 below (the premises) and I/we are making this application to you as the relevant licensing authority in accordance with section 12 of the Licensing Act 2003

Part 1 – Premises details

Postal address of premises or, if none, ordnance survey map reference or description			
Waters Edge Café 19 Coombe Street			
Post town	Lyme Regis	Postcode	DT7 3PR

Telephone number at premises (if any)	01297 599 354
Non-domestic rateable value of premises	£ 4,000

Part 2 - Applicant details

Please state whether you are applying for a premises licence as appropriate

Please tick as

- | | | |
|--|--------------------------|-----------------------------|
| a) an individual or individuals * | X | please complete section (A) |
| b) a person other than an individual * | | |
| i as a limited company/limited liability partnership | <input type="checkbox"/> | please complete section (B) |
| ii as a partnership (other than limited liability) | <input type="checkbox"/> | please complete section (B) |
| iii as an unincorporated association or | <input type="checkbox"/> | please complete section (B) |
| iv other (for example a statutory corporation) | <input type="checkbox"/> | please complete section (B) |
| c) a recognised club | <input type="checkbox"/> | please complete section (B) |

- d) a charity please complete section (B)
- e) the proprietor of an educational establishment please complete section (B)
- f) a health service body please complete section (B)
- g) a person who is registered under Part 2 of the Care Standards Act 2000 (c14) in respect of an independent hospital in Wales please complete section (B)
- ga) a person who is registered under Chapter 2 of Part 1 of the Health and Social Care Act 2008 (within the meaning of that Part) in an independent hospital in England please complete section (B)
- h) the chief officer of police of a police force in England and Wales please complete section (B)

* If you are applying as a person described in (a) or (b) please confirm (by ticking yes to one box below):

- I am carrying on or proposing to carry on a business which involves the use of the premises for licensable activities; or
- I am making the application pursuant to a
 statutory function or
 a function discharged by virtue of Her Majesty's prerogative

(A) INDIVIDUAL APPLICANTS (fill in as applicable)

Mr <input checked="" type="checkbox"/>	Mrs <input type="checkbox"/>	Miss <input type="checkbox"/>	Ms <input type="checkbox"/>	Other Title (for example, Rev)	
Surname Dellbridge			First names Jason		
Date of birth [REDACTED]		I am 18 years old or over <input checked="" type="checkbox"/> Please tick yes			
Nationality British					
Current residential address if different from premises address		[REDACTED]			
Post town	[REDACTED]	Postcode	[REDACTED]		
Daytime contact telephone number		[REDACTED]			
E-mail address (optional)		[REDACTED]			
Where applicable (if demonstrating a right to work via the Home Office online right to work checking service), the 9-digit 'share code' provided to the applicant by that service (please see note 15 for information)					
Scanned copy of (expired) passport submitted with this application					

SECOND INDIVIDUAL APPLICANT (if applicable)

Mr <input type="checkbox"/>	Mrs <input type="checkbox"/>	Miss <input type="checkbox"/>	Ms <input type="checkbox"/>	Other Title (for example, Rev)	
Surname			First names		
Date of birth over		I am 18 years old or		<input type="checkbox"/>	Please tick yes
Nationality					
Where applicable (if demonstrating a right to work via the Home Office online right to work checking service), the 9-digit 'share code' provided to the applicant by that service: (please see note 15 for information)					
Current residential address if different from premises address					
Post town				Postcode	
Daytime contact telephone number					
E-mail address (optional)					

(B) OTHER APPLICANTS

Please provide name and registered address of applicant in full. Where appropriate please give any registered number. In the case of a partnership or other joint venture (other than a body corporate), please give the name and address of each party concerned.

Name
Address
Registered number (where applicable)

Description of applicant (for example, partnership, company, unincorporated association etc.)
Telephone number (if any)
E-mail address (optional)

Part 3 Operating Schedule

When do you want the premises licence to start?

As soon as possible

If you wish the licence to be valid only for a limited period, when do you want it to end?

DD	MM	YYYY

Please give a general description of the premises (please read guidance note 1)

A small café which predominantly serves cold food and hot and cold drinks (that are prepared on-site) for consumption on and off the premises.

There are tables and seating within the premises and on a small outside area adjacent the back door.

The premises licence is required to enable the sale of wine to customers when having their meal.

If 5,000 or more people are expected to attend the premises at any one time, please state the number expected to attend.

What licensable activities do you intend to carry on from the premises? None

(please see sections 1 and 14 and Schedules 1 and 2 to the Licensing Act 2003)

- | Provision of regulated entertainment (please read guidance note 2) | Please tick all that apply |
|--|----------------------------|
| a) plays (if ticking yes, fill in box A) | <input type="checkbox"/> |
| b) films (if ticking yes, fill in box B) | <input type="checkbox"/> |
| c) indoor sporting events (if ticking yes, fill in box C) | <input type="checkbox"/> |
| d) boxing or wrestling entertainment (if ticking yes, fill in box D) | <input type="checkbox"/> |
| e) live music (if ticking yes, fill in box E) | <input type="checkbox"/> |
| f) recorded music (if ticking yes, fill in box F) | <input type="checkbox"/> |

g) performances of dance (if ticking yes, fill in box G)

h) anything of a similar description to that falling within (e), (f) or (g)
(if ticking yes, fill in box H)

Provision of late night refreshment (if ticking yes, fill in box I)

Supply of alcohol (if ticking yes, fill in box J) X

In all cases complete boxes K, L and M

A

Plays Standard days and timings (please read guidance note 7)			Will the performance of a play take place indoors or outdoors or both – please tick (please read guidance note 3)	Indoors	<input type="checkbox"/>
Day	Start	Finish		Outdoors	<input type="checkbox"/>
Mon			Please give further details here (please read guidance note 4)		
Tue					
Wed			State any seasonal variations for performing plays (please read guidance note 5)		
Thur					
Fri			Non standard timings. Where you intend to use the premises for the performance of plays at different times to those listed in the column on the left, please list (please read guidance note 6)		
Sat					
Sun					

B

Films Standard days and timings (please read guidance note 7)			Will the exhibition of films take place indoors or outdoors or both – please tick (please read guidance note 3)	Indoors	<input type="checkbox"/>
				Outdoors	<input type="checkbox"/>
				Both	<input type="checkbox"/>
Day	Start	Finish	<u>Please give further details here</u> (please read guidance note 4)		
Mon					
Tue					
Wed					
Thur					
Fri					
Sat					
			<u>State any seasonal variations for the exhibition of films</u> (please read guidance note 5)		
			<u>Non standard timings. Where you intend to use the premises for the exhibition of films at different times to those listed in the column on the left, please list</u> (please read guidance note 6)		
Sun					

C

Indoor sporting events Standard days and timings (please read guidance note 7)			Please give further details (please read guidance note 4)
Day	Start	Finish	
Mon			
Tue			State any seasonal variations for indoor sporting events (please read guidance note 5)
Wed			
Thur			Non standard timings. Where you intend to use the premises for indoor sporting events at different times to those listed in the column on the left, please list (please read guidance note 6)
Fri			
Sat			
Sun			

D

Boxing or wrestling entertainments Standard days and timings (please read guidance note 7)			Will the boxing or wrestling entertainment take place indoors or outdoors or both – please tick (please read guidance note 3)	Indoors	<input checked="" type="checkbox"/>
				Outdoors	<input type="checkbox"/>
				Both	<input type="checkbox"/>
Day	Start	Finish	Please give further details here (please read guidance note 4)		
Mon					
Tue					
Wed					
			State any seasonal variations for boxing or wrestling entertainment (please read guidance note 5)		
Thur					
Fri					
Sat					
Sun					
			Non standard timings. Where you intend to use the premises for boxing or wrestling entertainment at different times to those listed in the column on the left, please list (please read guidance note 6)		

E

Live music Standard days and timings (please read guidance note 7)			Will the performance of live music take place indoors or outdoors or both – please tick (please read guidance note 3)		Indoors	<input type="checkbox"/>
					Outdoors	<input type="checkbox"/>
Day	Start	Finish			Both	<input type="checkbox"/>
Mon			Please give further details here (please read guidance note 4)			
Tue						
Wed			State any seasonal variations for the performance of live music (please read guidance note 5)			
Thur						
Fri			Non standard timings. Where you intend to use the premises for the performance of live music at different times to those listed in the column on the left, please list (please read guidance note 6)			
Sat						
Sun						

F

Recorded music Standard days and timings (please read guidance note 7)			Will the playing of recorded music take place indoors or outdoors or both – please tick (please read guidance note 3)		Indoors	<input type="checkbox"/>
					Outdoors	<input type="checkbox"/>
					Both	<input type="checkbox"/>
Day	Start	Finish	Please give further details here (please read guidance note 4)			
Mon						
Tue						
			State any seasonal variations for the playing of recorded music (please read guidance note 5)			
Wed						
Thur						
			Non standard timings. Where you intend to use the premises for the playing of recorded music at different times to those listed in the column on the left, please list (please read guidance note 6)			
Fri						
Sat						
Sun						

G

Performances of dance Standard days and timings (please read guidance note 7)			Will the performance of dance take place indoors or outdoors or both – please tick (please read guidance note 3)	Indoors	<input type="checkbox"/>
				Outdoors	<input type="checkbox"/>
				Both	<input type="checkbox"/>
Day	Start	Finish	Please give further details here (please read guidance note 4)		
Mon					
Tue					
Wed					
			State any seasonal variations for the performance of dance (please read guidance note 5)		
Thur			Non standard timings. Where you intend to use the premises for the performance of dance at different times to those listed in the column on the left, please list (please read guidance note 6)		
Fri					
Sat					
Sun					

H

<p>Anything of a similar description to that falling within (e), (f) or (g) Standard days and timings (please read guidance note 7)</p>			<p>Please give a description of the type of entertainment you will be providing</p>		
Day	Start	Finish	<p><u>Will this entertainment take place indoors or outdoors or both – please tick</u> (please read guidance note 3)</p>	Indoors	<input type="checkbox"/>
Mon				Outdoors	<input type="checkbox"/>
				Both	<input type="checkbox"/>
Tue			<p><u>Please give further details here</u> (please read guidance note 4)</p>		
Wed					
Thur			<p><u>State any seasonal variations for entertainment of a similar description to that falling within (e), (f) or (g)</u> (please read guidance note 5)</p>		
Fri					
Sat			<p><u>Non standard timings. Where you intend to use the premises for the entertainment of a similar description to that falling within (e), (f) or (g) at different times to those listed in the column on the left, please list</u> (please read guidance note 6)</p>		
Sun					

I

Late night refreshment Standard days and timings (please read guidance note 7)			Will the provision of late night refreshment take place indoors or outdoors or both – please tick (please read guidance note 3)	Indoors	<input type="checkbox"/>
				Outdoors	<input type="checkbox"/>
				Both	<input type="checkbox"/>
Day	Start	Finish	<u>Please give further details here</u> (please read guidance note 4)		
Mon					
Tue			<u>State any seasonal variations for the provision of late night refreshment</u> (please read guidance note 5)		
Wed					
Thur			<u>Non standard timings. Where you intend to use the premises for the provision of late night refreshment at different times, to those listed in the column on the left, please list</u> (please read guidance note 6)		
Fri					
Sat					
Sun					

J

Supply of alcohol Standard days and timings (please read guidance note 7)			Will the supply of alcohol be for consumption – please tick (please read guidance note 8)	On the premises	<input checked="" type="checkbox"/>			
				Off the premises	<input type="checkbox"/>			
				Both	<input type="checkbox"/>			
Day	Start	Finish	State any seasonal variations for the supply of alcohol (please read guidance note 5) None					
Mon	11:00	21:00						
Tue	11:00	21:00						
Wed	11:00	21:00						
Thur	11:00	21:00						
Fri	11:00	21:00						
Sat	11:00	21:00						
Sun	11:00	21:00						
						Non standard timings. Where you intend to use the premises for the supply of alcohol at different times to those listed in the column on the left, please list (please read guidance note 6)		
						None		

State the name and details of the individual whom you wish to specify on the licence as designated premises supervisor (Please see declaration about the entitlement to work in the checklist at the end of the form):

Name	Jason Dellbridge
Date of birth	██████████
Address	██████████ ██████████
Postcode	██████████
Personal licence number (if known)	██████████
Issuing licensing authority (if known)	Buckingham Council (formerly issued by Wycombe District Council)

K

Please highlight any adult entertainment or services, activities, other entertainment or matters ancillary to the use of the premises that may give rise to concern in respect of children (please read guidance note 9).

None

L

Hours premises are open to the public Standard days and timings (please read guidance note 7)			State any seasonal variations (please read guidance note 5)
Day	Start	Finish	None
Mon	8:00		
		21:00	
Tue	8:00		
		21:00	
Wed	8:00		
		21:00	
Thur	8:00		
		21:00	
Fri	8:00		
		21:00	
Sat	8:00		
		21:00	
Sun	10:00		
		21:00	
			Non standard timings. Where you intend the premises to be open to the public at different times from those listed in the column on the left, please list (please read guidance note 6)
			None

M

Describe the steps you intend to take to promote the four licensing objectives:

a) General – all four licensing objectives (b, c, d and e) (please read guidance note 10)

The applicant is a knowledgeable and responsible person who has considerable experience in the requirements and legislation relating to the sale of alcohol and the need to adhere to the 4 licensing objectives outlined below.

He has previously held premises licences and holds a personal licence.

The small size of the premises helps achieve the licensing objectives.

b) The prevention of crime and disorder

The size of the premises and the limited nature of the alcohol to be provided (predominantly wine) will enable staff to easily identify potential for and prevent crime and disorder.

c) Public safety

The size of the premises enables staff to easily ensure public safety.

d) The prevention of public nuisance

The size of the premises enables staff to prevent and address any public nuisance.

Imposition of Condition E1, E5 and E17 may be appropriate.

e) The protection of children from harm

The size of the premises enables staff to easily ensure the protection of children.

Imposition of Condition D5, E1, E5 and E17 may be appropriate.

Checklist:

Please tick to indicate agreement

- | | |
|--|--|
| ● I have made or enclosed payment of the fee. | To follow after submitting application |
| ● I have enclosed the plan of the premises. | X |
| ● I have sent copies of this application and the plan to responsible authorities and others where applicable. | N/A |
| ● I have enclosed the consent form completed by the individual I wish to be designated premises supervisor, if applicable. | X |
| ● I understand that I must now advertise my application. | X |
| ● I understand that if I do not comply with the above requirements my application will be rejected. | X |
| ● [Applicable to all individual applicants, including those in a partnership which is not a limited liability partnership, but not companies or limited liability partnerships] I have included documents demonstrating my entitlement to work in the United Kingdom or my share code issued by the Home Office online right to work checking service (please read note 15). | X |

IT IS AN OFFENCE, UNDER SECTION 158 OF THE LICENSING ACT 2003, TO MAKE A FALSE STATEMENT IN OR IN CONNECTION WITH THIS APPLICATION. THOSE WHO MAKE A FALSE STATEMENT MAY BE LIABLE ON SUMMARY CONVICTION TO A FINE OF ANY AMOUNT.

IT IS AN OFFENCE UNDER SECTION 24B OF THE IMMIGRATION ACT 1971 FOR A PERSON TO WORK WHEN THEY KNOW, OR HAVE REASONABLE CAUSE TO BELIEVE, THAT THEY ARE DISQUALIFIED FROM DOING SO BY REASON OF THEIR IMMIGRATION STATUS. THOSE WHO EMPLOY AN ADULT WITHOUT LEAVE OR WHO IS SUBJECT TO CONDITIONS AS TO EMPLOYMENT WILL BE LIABLE TO A CIVIL PENALTY UNDER SECTION 15 OF THE IMMIGRATION, ASYLUM AND NATIONALITY ACT 2006 AND PURSUANT TO SECTION 21 OF THE SAME ACT, WILL BE COMMITTING AN OFFENCE WHERE THEY DO SO IN THE KNOWLEDGE, OR WITH REASONABLE CAUSE TO BELIEVE, THAT THE EMPLOYEE IS DISQUALIFIED.

Part 4 – Signatures (please read guidance note 11)

Signature of applicant or applicant’s solicitor or other duly authorised agent (see guidance note 12). **If signing on behalf of the applicant, please state in what capacity.**

Declaration	<ul style="list-style-type: none">● [Applicable to individual applicants only, including those in a partnership which is not a limited liability partnership] I understand I am not entitled to be issued with a licence if I do not have the entitlement to live and work in the UK (or if I am subject to a condition preventing me from doing work relating to the carrying on of a licensable activity) and that my licence will become invalid if I cease to be entitled to live and work in the UK (please read guidance note 15).● The DPS named in this application form is entitled to work in the UK (and is not subject to conditions preventing him or her from doing work relating to a licensable activity) and I have seen a copy of his or her proof of entitlement to work, or have conducted an online right to work check using the Home Office online right to work checking service which confirmed their right to work (please see note 15)
--------------------	--

Signature	[REDACTED]
Date	06-10-2021
Capacity	Agent

For joint applications, signature of 2nd applicant or 2nd applicant's solicitor or other authorised agent (please read guidance note 13). If signing on behalf of the applicant, please state in what capacity.

Signature	
Date	
Capacity	

Contact name (where not previously given) and postal address for correspondence associated with this application (please read guidance note 14)			
S J Graeser, Stephen Graeser Planning, [REDACTED]			
Post town	Blandford Forum	Postcode	[REDACTED]
Telephone number (if any)	[REDACTED]	[REDACTED]	
If you would prefer us to correspond with you by e-mail, your e-mail address (optional)			
[REDACTED]			

Notes for Guidance

1. Describe the premises, for example the type of premises, its general situation and layout and any other information which could be relevant to the licensing objectives. Where your application includes off-supplies of alcohol and you intend to provide a

place for consumption of these off-supplies, you must include a description of where the place will be and its proximity to the premises.

2. In terms of specific regulated entertainments please note that:
 - Plays: no licence is required for performances between 08:00 and 23.00 on any day, provided that the audience does not exceed 500.
 - Films: no licence is required for 'not-for-profit' film exhibition held in community premises between 08.00 and 23.00 on any day provided that the audience does not exceed 500 and the organiser (a) gets consent to the screening from a person who is responsible for the premises; and (b) ensures that each such screening abides by age classification ratings.
 - Indoor sporting events: no licence is required for performances between 08.00 and 23.00 on any day, provided that the audience does not exceed 1000.
 - Boxing or Wrestling Entertainment: no licence is required for a contest, exhibition or display of Greco-Roman wrestling, or freestyle wrestling between 08.00 and 23.00 on any day, provided that the audience does not exceed 1000. Combined fighting sports – defined as a contest, exhibition or display which combines boxing or wrestling with one or more martial arts – are licensable as a boxing or wrestling entertainment rather than an indoor sporting event.
 - Live music: no licence permission is required for:
 - a performance of unamplified live music between 08.00 and 23.00 on any day, on any premises.
 - a performance of amplified live music between 08.00 and 23.00 on any day on premises authorised to sell alcohol for consumption on those premises, provided that the audience does not exceed 500.
 - a performance of amplified live music between 08.00 and 23.00 on any day, in a workplace that is not licensed to sell alcohol on those premises, provided that the audience does not exceed 500.
 - a performance of amplified live music between 08.00 and 23.00 on any day, in a church hall, village hall, community hall, or other similar community premises, that is not licensed by a premises licence to sell alcohol, provided that (a) the audience does not exceed 500, and (b) the organiser gets consent for the performance from a person who is responsible for the premises.
 - a performance of amplified live music between 08.00 and 23.00 on any day, at the non-residential premises of (i) a local authority, or (ii) a school, or (iii) a hospital, provided that (a) the audience does not exceed 500, and (b) the organiser gets consent for the performance on the relevant premises from: (i) the local authority concerned, or (ii) the school or (iii) the health care provider for the hospital.
 - Recorded Music: no licence permission is required for:
 - any playing of recorded music between 08.00 and 23.00 on any day on premises authorised to sell alcohol for consumption on those premises, provided that the audience does not exceed 500.
 - any playing of recorded music between 08.00 and 23.00 on any day, in a church hall, village hall, community hall, or other similar community premises, that is not licensed by a premises licence to sell alcohol, provided that (a) the audience does not exceed 500, and (b) the organiser gets consent for the performance from a person who is responsible for the premises.
 - any playing of recorded music between 08.00 and 23.00 on any day, at the non-residential premises of (i) a local authority, or (ii) a school, or (iii) a hospital, provided that (a) the audience does not exceed 500, and (b) the organiser gets consent for the performance on the relevant premises from: (i) the local authority concerned, or (ii) the school proprietor or (iii) the health care provider for the hospital.
 - Dance: no licence is required for performances between 08.00 and 23.00 on any day, provided that the audience does not exceed 500. However, a performance which amounts to adult entertainment remains licensable.

- Cross activity exemptions: no licence is required between 08.00 and 23.00 on any day, with no limit on audience size for:
 - any entertainment taking place on the premises of the local authority where the entertainment is provided by or on behalf of the local authority;
 - any entertainment taking place on the hospital premises of the health care provider where the entertainment is provided by or on behalf of the health care provider;
 - any entertainment taking place on the premises of the school where the entertainment is provided by or on behalf of the school proprietor; and
 - any entertainment (excluding films and a boxing or wrestling entertainment) taking place at a travelling circus, provided that (a) it takes place within a moveable structure that accommodates the audience, and (b) that the travelling circus has not been located on the same site for more than 28 consecutive days.
3. Where taking place in a building or other structure please tick as appropriate (indoors may include a tent).
 4. For example the type of activity to be authorised, if not already stated, and give relevant further details, for example (but not exclusively) whether or not music will be amplified or unamplified.
 5. For example (but not exclusively), where the activity will occur on additional days during the summer months.
 6. For example (but not exclusively), where you wish the activity to go on longer on a particular day e.g. Christmas Eve.
 7. Please give timings in 24 hour clock (e.g. 16.00) and only give details for the days of the week when you intend the premises to be used for the activity.
 8. If you wish people to be able to consume alcohol on the premises, please tick 'on the premises'. If you wish people to be able to purchase alcohol to consume away from the premises, please tick 'off the premises'. If you wish people to be able to do both, please tick 'both'.
 9. Please give information about anything intended to occur at the premises or ancillary to the use of the premises which may give rise to concern in respect of children, regardless of whether you intend children to have access to the premises, for example (but not exclusively) nudity or semi-nudity, films for restricted age groups or the presence of gaming machines.
 10. Please list here steps you will take to promote all four licensing objectives together.
 11. The application form must be signed.
 12. An applicant's agent (for example solicitor) may sign the form on their behalf provided that they have actual authority to do so.
 13. Where there is more than one applicant, each of the applicants or their respective agent must sign the application form.
 14. This is the address which we shall use to correspond with you about this application.

15. Entitlement to work/immigration status for individual applicants and applications

from partnerships which are not limited liability partnerships:

A licence may not be held by an individual or an individual in a partnership who is resident in the UK who:

- does not have the right to live and work in the UK; or
- is subject to a condition preventing him or her from doing work relating to the carrying on of a licensable activity.

Any premises licence issued in respect of an application made on or after 6 April 2017 will become invalid if the holder ceases to be entitled to work in the UK.

Applicants must demonstrate that they have an entitlement to work in the UK and are not subject to a condition preventing them from doing work relating to the carrying on of a licensable activity. They do this in one of two ways: 1) by providing with this

application copies or scanned copies of the documents listed below (which do not need to be certified), or 2) by providing their 'share code' to enable the licensing authority to carry out a check using the Home Office online right to work checking service (see below).

Documents which demonstrate entitlement to work in the UK

- An expired or current passport showing the holder, or a person named in the passport as the child of the holder, is a British citizen or a citizen of the UK and Colonies having the right of abode in the UK [please see note below about which sections of the passport to copy].
- An expired or current passport or national identity card showing the holder, or a person named in the passport as the child of the holder, is a national of a European Economic Area country or Switzerland.
- A Registration Certificate or document certifying permanent residence issued by the Home Office to a national of a European Economic Area country or Switzerland.
- A Permanent Residence Card issued by the Home Office to the family member of a national of a European Economic Area country or Switzerland.
- A **current** Biometric Immigration Document (Biometric Residence Permit) issued by the Home Office to the holder indicating that the person named is allowed to stay indefinitely in the UK, or has no time limit on their stay in the UK.
- A **current** passport endorsed to show that the holder is exempt from immigration control, is allowed to stay indefinitely in the UK, has the right of abode in the UK, or has no time limit on their stay in the UK.
- A **current** Immigration Status Document issued by the Home Office to the holder with an endorsement indicating that the named person is allowed to stay indefinitely in the UK or has no time limit on their stay in the UK, **when produced in combination with** an official document giving the person's permanent National Insurance number and their name issued by a Government agency or a previous employer.
- A birth or adoption certificate issued in the UK, **when produced in combination with** an official document giving the person's permanent National Insurance number and their name issued by a Government agency or a previous employer.
- A birth or adoption certificate issued in the Channel Islands, the Isle of Man or Ireland **when produced in combination with** an official document giving the person's permanent National Insurance number and their name issued by a Government agency or a previous employer.
- A certificate of registration or naturalisation as a British citizen, **when produced in combination with** an official document giving the person's permanent National Insurance number and their name issued by a Government agency or a previous employer.

- A **current** passport endorsed to show that the holder is allowed to stay in the UK and is currently allowed to work and is not subject to a condition preventing the holder from doing work relating to the carrying on of a licensable activity.
- A **current** Biometric Immigration Document (Biometric Residence Permit) issued by the Home Office to the holder which indicates that the named person can currently stay in the UK and is allowed to work relation to the carrying on of a licensable activity.
- A **current** Residence Card issued by the Home Office to a person who is not a national of a European Economic Area state or Switzerland but who is a family member of such a national or who has derivative rights or residence.
- A **current** Immigration Status Document containing a photograph issued by the Home Office to the holder with an endorsement indicating that the named person may stay in the UK, and is allowed to work and is not subject to a condition preventing the holder from doing work relating to the carrying on of a licensable activity **when produced in combination with** an official document giving the person's permanent National Insurance number and their name issued by a Government agency or a previous employer.
- A Certificate of Application, **less than 6 months old**, issued by the Home Office under regulation 18(3) or 20(2) of the Immigration (European Economic Area) Regulations 2016, to a person who is not a national of a European Economic Area state or Switzerland but who is a family member of such a national or who has derivative rights of residence.
- Reasonable evidence that the person has an outstanding application to vary their permission to be in the UK with the Home Office such as the Home Office acknowledgement letter or proof of postage evidence, or reasonable evidence that the person has an appeal or administrative review pending on an immigration decision, such as an appeal or administrative review reference number.
- Reasonable evidence that a person who is not a national of a European Economic Area state or Switzerland but who is a family member of such a national or who has derivative rights of residence in exercising treaty rights in the UK including:
 - evidence of the applicant's own identity – such as a passport,
 - evidence of their relationship with the European Economic Area family member – e.g. a marriage certificate, civil partnership certificate or birth certificate, and
 - evidence that the European Economic Area national has a right of permanent residence in the UK or is one of the following if they have been in the UK for more than 3 months:
 - (i) working e.g. employment contract, wage slips, letter from the employer,
 - (ii) self-employed e.g. contracts, invoices, or audited accounts with a bank,
 - (iii) studying e.g. letter from the school, college or university and evidence of sufficient funds; or
 - (iv) self-sufficient e.g. bank statements.

Family members of European Economic Area nationals who are studying or financially independent must also provide evidence that the European Economic Area national and

any family members hold comprehensive sickness insurance in the UK. This can include a private medical insurance policy, an EHIC card or an S1, S2 or S3 form.

Original documents must not be sent to licensing authorities. If the document copied is a passport, a copy of the following pages should be provided:

- (i) any page containing the holder's personal details including nationality;
- (ii) any page containing the holder's photograph;
- (iii) any page containing the holder's signature;
- (iv) any page containing the date of expiry; and
- (v) any page containing information indicating the holder has permission to enter or remain in the UK and is permitted to work.

If the document is not a passport, a copy of the whole document should be provided.

Your right to work will be checked as part of your licensing application and this could involve us checking your immigration status with the Home Office. We may otherwise share information with the Home Office. Your licence application will not be determined until you have complied with this guidance.

Home Office online right to work checking service

As an alternative to providing a copy of the documents listed above, applicants may demonstrate their right to work by allowing the licensing authority to carry out a check with the Home Office online right to work checking service.

To demonstrate their right to work via the Home Office online right to work checking service, applicants should include in this application their 9-digit share code (provided to them upon accessing the service at <https://www.gov.uk/prove-right-to-work>) which, along with the applicant's date of birth (provided within this application), will allow the licensing authority to carry out the check.

In order to establish the applicant's right to work, the check will need to indicate that the applicant is allowed to work in the United Kingdom and is not subject to a condition preventing them from doing work relating to the carrying on of a licensable activity.

An online check will not be possible in all circumstances because not all applicants will have an immigration status that can be checked online. The Home Office online right to work checking service sets out what information and/or documentation applicants will need in order to access the service. Applicants who are unable to obtain a share code from the service should submit copy documents as set out above.

Ground Floor Premises
 19 Coombe Street, Lyme Regis
 DT7 3PR

Drawing Number 163-04

Proposed Floor Plan

Scale 1:50 @ A4

0 0.5 1.0 1.5 2.0
 +-----+-----+-----+-----+
 Metres

© Copyright Stephen Graeser Planning.
 For planning application purposes only.

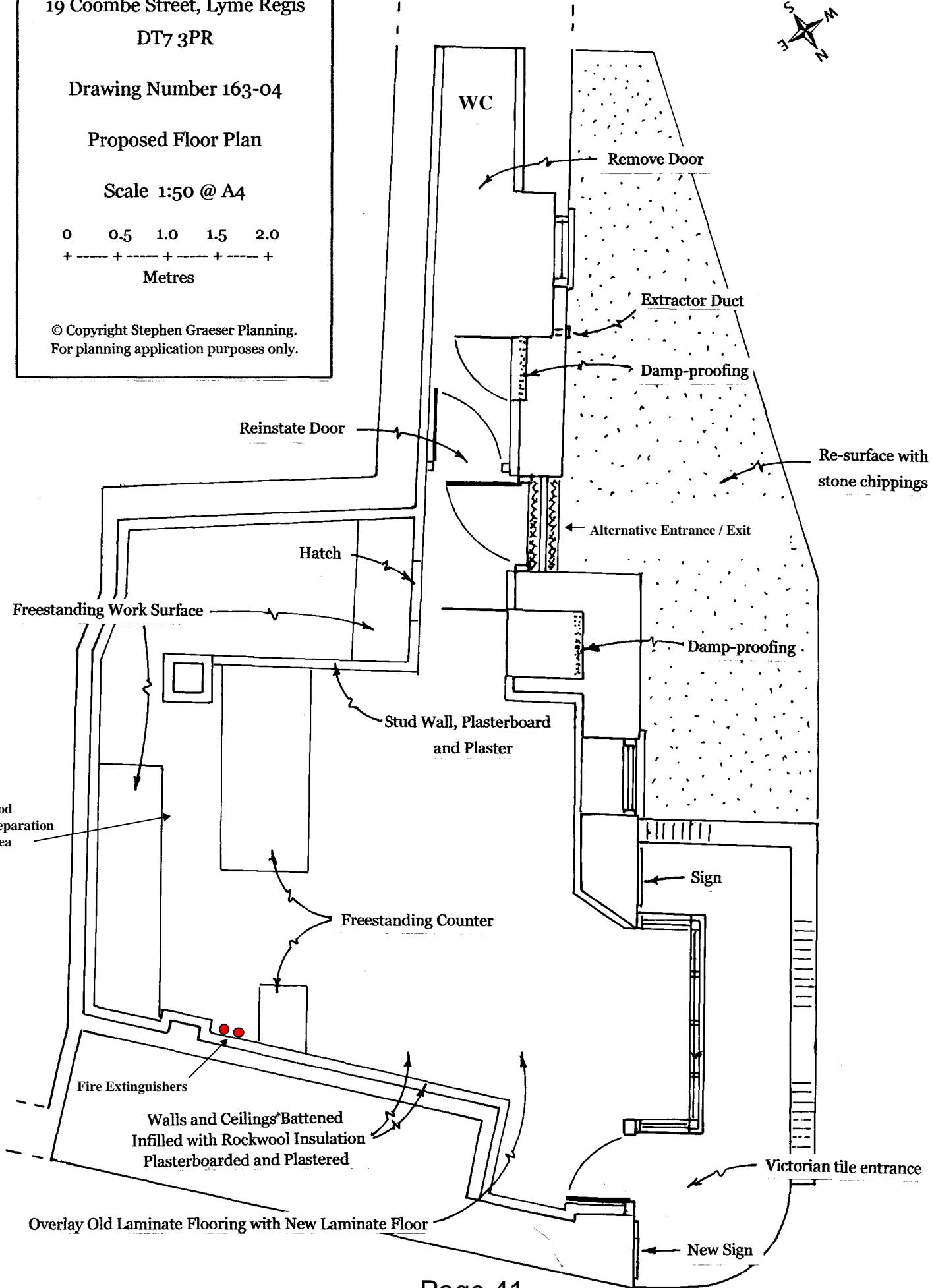

This page is intentionally left blank

STEPHEN GRAESER PLANNING

E-mail: sgraeserplanning@gmail.com
www.sgraeserplanning.co.uk

Ground Floor Premises - 19 Coombe Street, Lyme Regis DT7 3PR

Drawing Number 163-02 Site Plan Scale 1:200 @ A4

© Copyright Stephen Graeser Planning. For planning application purposes only.

This map is based upon Ordnance Survey material with the permission of Ordnance Survey on behalf of Her Majesty's Stationary Office. © Crown copyright and database rights - Ordnance Survey Licence Number 0100053406. Unauthorised reproduction infringes Crown copyright and may lead to prosecution or civil proceedings.

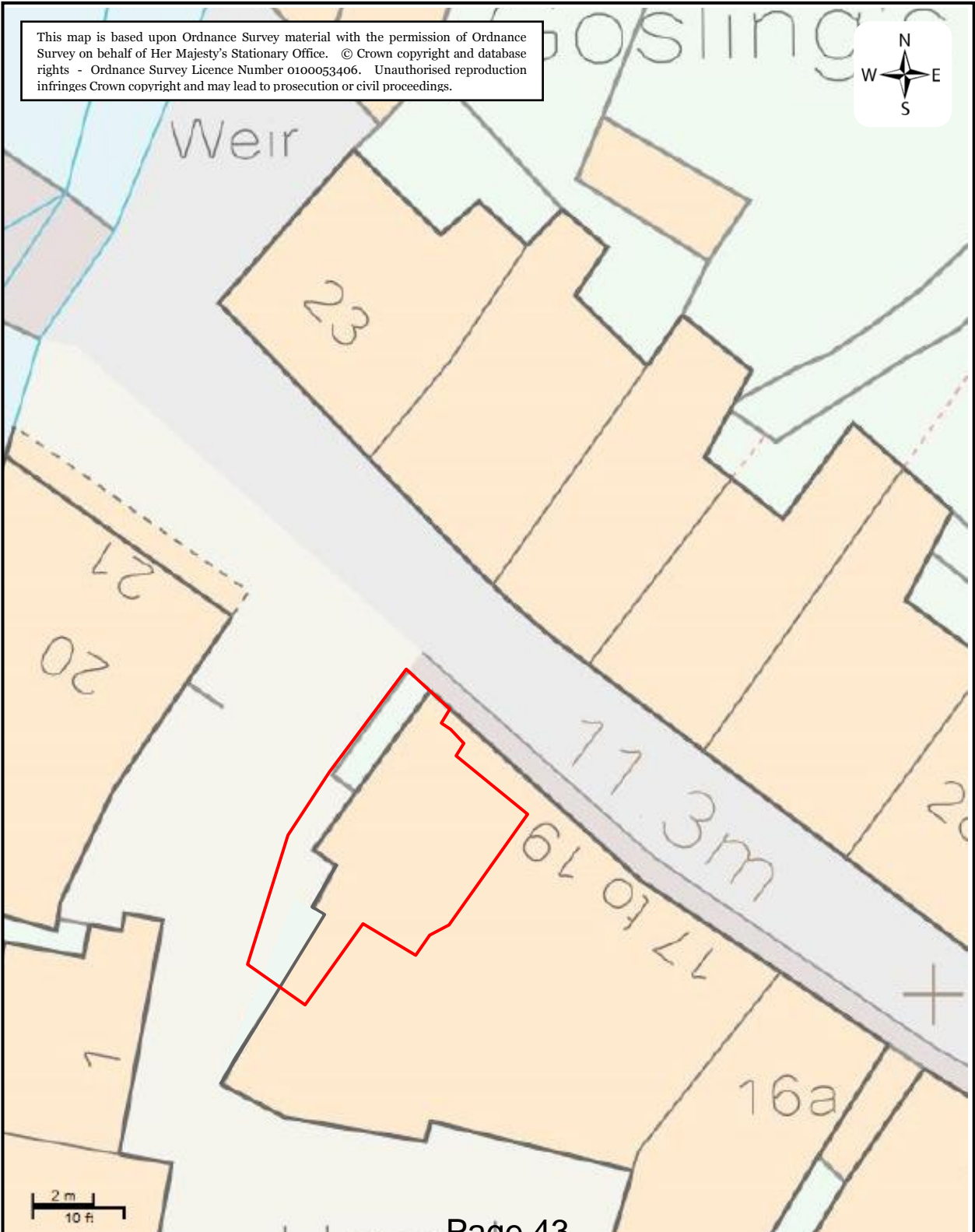

This page is intentionally left blank

STEPHEN GRAESER PLANNING

E-mail: sgraeserplanning@gmail.com
www.sgraeserplanning.co.uk

Ground Floor Premises - 19 Coombe Street, Lyme Regis DT7 3PR

Drawing Number 163-08 Location Plan Scale 1:1250 @ A4

© Copyright Stephen Graeser Planning. For planning application purposes only.



This page is intentionally left blank

The Waters Edge Cafe at number 19 Coombe Street has applied for a alcohol licence in addition to changing its opening hours. When the cafe first opened it was agreed with the landlord that the cafe would open from 9am till 5pm, as the cafe is in a residential area this would be the least disruptive to the neighbours.

This application to now serve alcohol and open till 9pm will be very disruptive. My husband and I both have jobs which start early in the morning , therefor we tend to go to bed fairly early, in addition the cafe seating area is within 1.5 metres from my door and I have no wish to have people sitting outside my house eating and drinking till 9pm. The cafe would then need to clean when the customers eventually left for the previous days trade, this could then become 10pm by the time the cafe closes. This cafe is within a mostly residential area and we object that granting this licence would be disruptive to the area.

STEPHEN GRAESER PLANNING

E-mail: sgraeserplanning@gmail.com
www.sgraeserplanning.co.uk

FAO Mr R Keepax, Licensing Officer
Dorset Council
South Walks House
South Walks Road
Dorchester
Dorset DT1 1UZ

13 October 2021

My Ref: 0163

Dear Mr Keepax,

Premises Licence Application for Mr Jason Dellbridge - 19 Coombe Street, Lyme Regis

Thank you for your e-mail of 13 October 2021 advising of the objection to the licensing application I have submitted on behalf of Mr Jason Dellbridge.

Through planning application number WD/D/20/000664 (as modified by application P-VoC-2021-00169) I obtained planning permission for the change of use of the ground floor premises at 19 Coombe Street to a café which predominantly sells hot and cold drinks, cold food and a limited range of hot food (warmed sausage rolls etc) for consumption on and off the premises.

The limited size of the premises restricts the number of people who can sit and consume their food and drink, whether inside the premises or outside on the small gravelled courtyard.

To protect the amenities of nearby residents Dorset Council imposed a planning condition on the planning permission, restricting the opening times of the café from 08:00 to 17:00 on Monday to Saturday and from 9:00 to 17:00 on Sundays and Bank Holidays.

As you are already aware the premises licence has been submitted to enable Mr Dellbridge to sell glasses of wine to those customers who would like a glass of wine with their food. There are no plans to sell beer, lager or spirits etc.

The premises licence application has been made to enable the sale of alcohol on any day from 11:00 hours to 21:00 hours.

Under the current planning permission, if the licence application was approved and Mr Dellbridge wanted the premises to remain open after 17:00 hours another planning application, to vary the existing condition, would need to be submitted.

In their determination of such an application Dorset Council would again assess the impact on the amenities of nearby residents. If that impact was considered acceptable the application could be approved however, if the impact was considered to be unacceptable, the application would be refused.

As the legislative requirements and assessments of Licensing and Planning applications are distinctly separate, I do not consider it inappropriate to apply first for the licensing hours as per the current application and, at a later date, to apply to extend the opening hours.

The alternative method, to apply for planning permission to extend the opening hours first would, in my professional opinion, be difficult to justify in absence of a premises licence.

I would be grateful if you could pass this letter to the objectors. I sincerely trust that the explanations given above will address their concerns and they will be able to see that the licence application is not a 'back door' means of turning the café into a public house or for the use of the premises, when licenced, to have an adverse impact on the amenity of local residents.

Should they need any further information or wish to discuss the licence application with me I would be happy for them to contact me directly. Alternatively, I would not consider it unreasonable should they wish all communication to be via you.

If you require any further explanation or additional information in respect of the licence application, please do not hesitate to contact me,

Yours sincerely,



Stephen Graeser MA DipMS MRTPI
Independent Planning Consultant

Following the objection to the Premises Licence application my client has re-considered the matter.

Notwithstanding the letter responding to the objection, he would like to change the hour within which alcohol can be sold at the premises to be between 11:00 and 17:00 on any day.

This will ensure the licensing hours do not exceed the opening hours stipulated on the planning permission and will also ensure that the amenity of neighbours is not adversely affected.

I would be grateful if you could advise the objectors of this change.

This page is intentionally left blank

We would still like to register our concerns regarding granting an alcohol licence to Waters Edge Cafe.

The reason for this is this is still in a residential area and as the seating is as mentioned 1.5 meters from my door, which is my main entrance I would not feel comfortable or safe walking past people consuming alcohol especially when I have my grandchildren with me.

The current owner also has the business up for sale and although he has decided to not extend his opening hours if a licence was granted the new owner may have other plans.

This page is intentionally left blank

Document is Restricted

This page is intentionally left blank

Document is Restricted

This page is intentionally left blank

Document is Restricted

This page is intentionally left blank

Document is Restricted

This page is intentionally left blank

Document is Restricted

This page is intentionally left blank

Document is Restricted

This page is intentionally left blank

Document is Restricted

This page is intentionally left blank

Document is Restricted

This page is intentionally left blank

Document is Restricted

This page is intentionally left blank

Document is Restricted

This page is intentionally left blank

Document is Restricted

This page is intentionally left blank